

# HSF

NOTES:  
 Current Rating: 10A  
 Voltage Rating: 300V  
 Contact Resistance: 20milliohm Max  
 Withstand Voltage: AC2000V  
 Insulation Resistance: 1000Megohm Min  
 Screw Torque: 4.4 lbf.in  
 Wire range: 12-30AWG  
 Operation Temperature: -40℃ to +105℃

Housing Material: PA66 UL94V-0  
 Cover Material: PA66 UL94-V0  
 Screw: Steel  
 Pin Block: Brass  
 Contact: Phosphor Bronze

2P With 1 RAMP Locking "A"

### Ordering Information:

P F 500 - A XX A SM N 1

F=Female Pitch 500=5.00 No. of Pins 02-24P Color A=Green Contact Plated SM=Matte Tin Type N=Without Two Side Screw

|     |             |             |     |              |              |
|-----|-------------|-------------|-----|--------------|--------------|
| 13P | 65.08 ±0.40 | 60.00 ±0.35 |     |              |              |
| 12P | 60.08 ±0.40 | 55.00 ±0.35 | 24P | 120.08 ±0.40 | 115.00 ±0.40 |
| 11P | 55.08 ±0.40 | 50.00 ±0.30 | 23P | 115.08 ±0.40 | 110.00 ±0.40 |
| 10P | 50.08 ±0.35 | 45.00 ±0.30 | 22P | 110.08 ±0.40 | 105.00 ±0.40 |
| 9P  | 45.08 ±0.35 | 40.00 ±0.30 | 21P | 105.08 ±0.40 | 100.00 ±0.40 |
| 8P  | 40.08 ±0.35 | 35.00 ±0.30 | 20P | 100.08 ±0.40 | 95.00 ±0.35  |
| 7P  | 35.08 ±0.35 | 30.00 ±0.30 | 19P | 95.08 ±0.40  | 90.00 ±0.35  |
| 6P  | 30.08 ±0.35 | 25.00 ±0.30 | 18P | 90.08 ±0.40  | 85.00 ±0.35  |
| 5P  | 25.08 ±0.35 | 20.00 ±0.30 | 17P | 85.08 ±0.40  | 80.00 ±0.35  |
| 4P  | 20.08 ±0.35 | 15.00 ±0.30 | 16P | 80.08 ±0.40  | 75.00 ±0.35  |
| 3P  | 15.08 ±0.35 | 10.00 ±0.30 | 15P | 75.08 ±0.40  | 70.00 ±0.35  |
| 2P  | 10.08 ±0.35 | 5.00 ±0.30  | 14P | 70.08 ±0.40  | 65.00 ±0.35  |
| 位数  | A           | B           | 位数  | A            | B            |

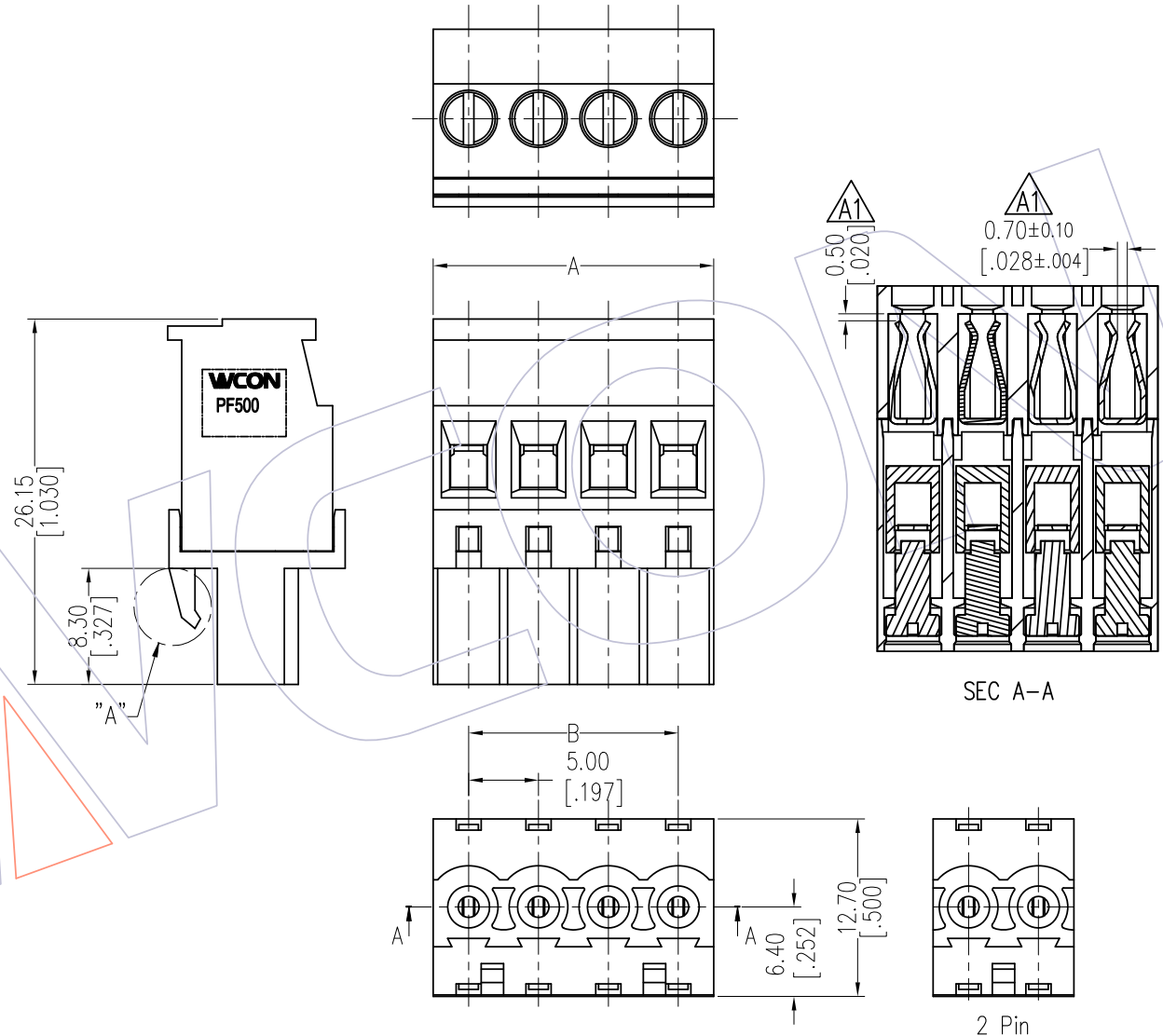

| REV | DATE       | MODIFICATION DESCRIPTION           | CHANGE | OPERATION   | DRAW    | DATE       | SCALE | FIT  | PART NO.                  |
|-----|------------|------------------------------------|--------|-------------|---------|------------|-------|------|---------------------------|
| A1  | 2019/05/19 | Add Explosion view & Material List |        | X.X ±0.40   | XSR     | 2019/05/19 | UNIT  | mm   | PF500-AXXASMN1            |
| A0  | 2019/03/19 | NEW                                |        | X.XX ±0.25  | CHECK   | DATE       | SIZE  | inch | TITLE:                    |
|     |            |                                    |        | X.XXX ±0.15 |         |            | SHEET | 1/2  | 5.00mm Pitch Female       |
|     |            |                                    |        | Angle ± 3°  | APPROVE | DATE       | PROJ. |      | Pluggable Terminal Blocks |
|     |            |                                    |        | DIM TOL     |         |            |       |      | Customer NO.              |

**WCON**  
[Http: www.wcon.com](http://www.wcon.com)

WCON-Dongguan  
 Tel: +86 769 85358920  
 Fax: +86 769 85358915  
 E-mail: sales@wcon.com

WCON-Kunshan  
 Tel: +86 512 57468408  
 Fax: +86 512 57468468  
 E-mail: salesks@wcon.com

HSF

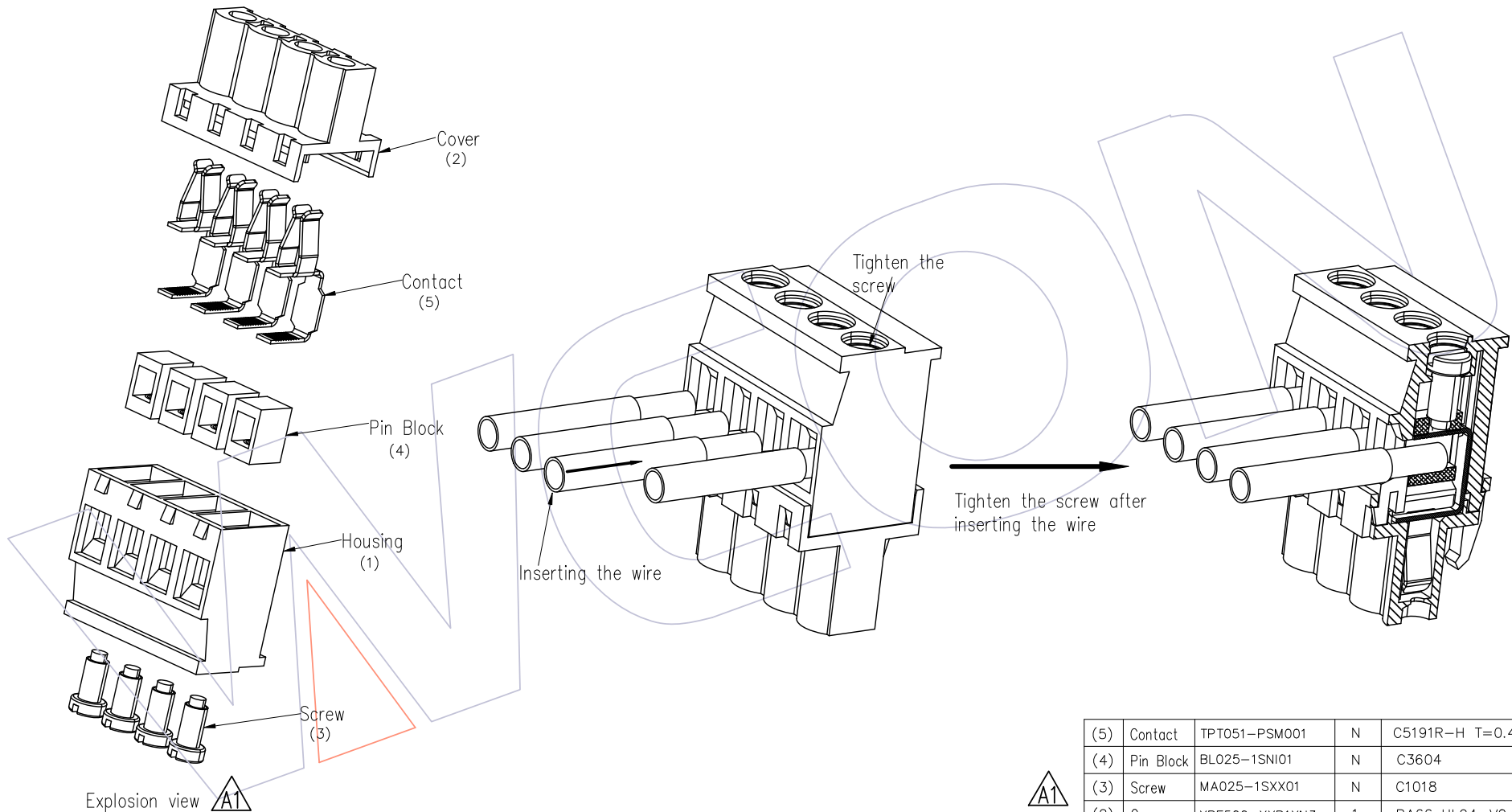

| ITEM | TITLE     | PART NO.       | Q'TY | Material         |
|------|-----------|----------------|------|------------------|
| (5)  | Contact   | TPT051-PSM001  | N    | C5191R-H T=0.4mm |
| (4)  | Pin Block | BL025-1SNI01   | N    | C3604            |
| (3)  | Screw     | MA025-1SXX01   | N    | C1018            |
| (2)  | Cover     | XPF500-XXB1XN3 | 1    | PA66 UL94-V0     |
| (1)  | Housing   | XPF500-XXB1XN2 | 1    | PA66 UL94-V0     |

| REV | DATE       | MODIFICATION DESCRIPTION           | CHANGE | OPERATION           | DRAW    | DATE       | SCALE | FIT                   | PART NO.   |
|-----|------------|------------------------------------|--------|---------------------|---------|------------|-------|-----------------------|--|
| A1  | 2019/05/19 | Add Explosion view & Material List | ---    | X.X $\pm 0.40$      | XSR     | 2019/05/19 | UNIT  | mm                    | PF500-AXXASMN1   |
| A0  | 2019/03/19 | NEW                                | ---    | X.XX $\pm 0.25$     | CHECK   | DATE       | inch  | SIZE                  |  |
|     |            |                                    |        | X.XXX $\pm 0.15$    | APPROVE | DATE       | SHEET | 2/2                   | TITLE:<br>5.00mm Pitch Female<br>Pluggable Terminal Blocks |
|     |            |                                    |        | Angle $\pm 3^\circ$ |         |            | PROJ. | $\diamond \leftarrow$ |  |
|     |            |                                    |        | DIM TOL             |         |            |       |                       | Customer NO.   |

**WCON**  
[Http: www.wcon.com](http://www.wcon.com)

WCON-Dongguan      WCON-Kunshan  
 Tel: +86 769 85358920      Tel: +86 512 57468408  
 Fax: +86 769 85358915      Fax: +86 512 57468468  
 E-mail: sales@wcon.com      E-mail: salesks@wcon.com